

C/E660 N C/E242



C/E660 N



Sistema Enterprise



Sistema Unger S5 (C/E660 N)

C/E660 N - C/E242



02/12

I DATI DEL PRESENTE CATALOGO NON SONO IMPREGNATIVI E POTRANNO SUBIRE VARIAZIONI SENZA PREAVVISO. SPECIFICAZIONI E ALTRE CARATTERISTICHE SONO SOGGETTE A CAMBIARE SENZA AVVERTENZA.

MEAT MINCER FOR PROFESSIONAL USE.

Heavy-duty. Reliable. Suitable for use in meat processing centres, supermarkets and hypermarkets, communities, ...

- Casing in AISI 304 stainless steel, with base and castors with brake. Large S/S feed pan (Compact removable on C/E660 N)
- External head for mass production in AISI 304 stainless steel (C/E660 N) or treated cast iron (C/E242):
Enterprise: 1 plate and one self-sharpening knife in stainless steel
Unger S5: Ø 98, 3 plates, 2 self-sharpening knives in stainless steel and two rings (C/E660 N)
- Removable mincing assembly for easy and quick cleaning 3-phases ventilated motor for continuous duty
- Electric components housed in an hermetic container with IP56 protection rating N.V.R. low voltage controls (24 V), forward, stop, reverse
- The machine complies with CE standards in terms of hygiene and safety and with the specific standards

On request

- Foot control (C/E660 N)
- Semi-automatic hamburger maker (C/E660 N)
- Special voltages, 60 Hz

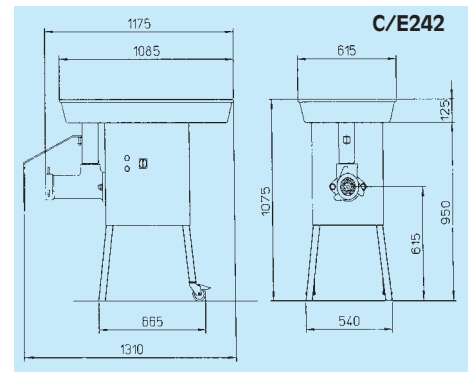
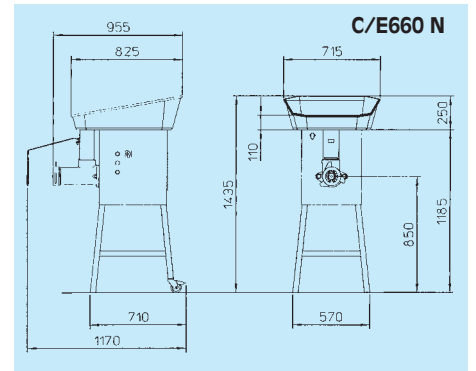

	C/E660 N	C/E242
Bocca - Head - Corps - Gehäuse - Boca	32/98	42/130
Capienza tramoggia - Feed pan capacity - Capacité bac - Trichterinhalt - Capacidad cuba	l	83
Produzione - Output - Production - Produktion - Produccion	kg/h (hg/min)	1.500 (25) 1.800 (30)
Potenza - Power - Puissance - Leistung - Potencia	kW (HP)	4 (5,5) 5,25 (7)
Peso netto - Net weight - Poids net - Nettogewicht - Peso neto	kg	117 135



Minerva Omega group s.r.l.



Aishwarya
FOOD SERVICE EQUIPMENT
Aishwarya Consolidates Pvt. Ltd.,
#19, First Floor, 10th B Main, 27th Cross,
Third Block Jayanagar, BANGALORE - 560 011, INDIA
Tel: +91-80-2664 1200/1/2 Fax: +91-80-2664 1204
E-mail : aishtek@vsnl.com www.aishwaryaconsolidates.com